

GO Easy - Replacing a Fender

Step 1: Stabilize the GO Easy by placing blocks under the opposite side to be replaced. Use a jack to lift the GO Easy on the side to be replaced.

Step 2:

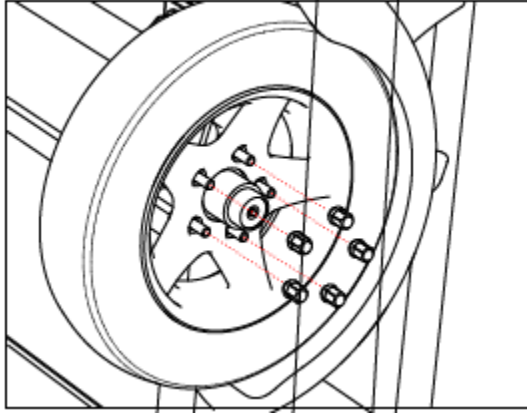

Remove the lug nuts and wheel.

Parts:

- 1 – wheel
- 5 – lug nuts

Step 3:

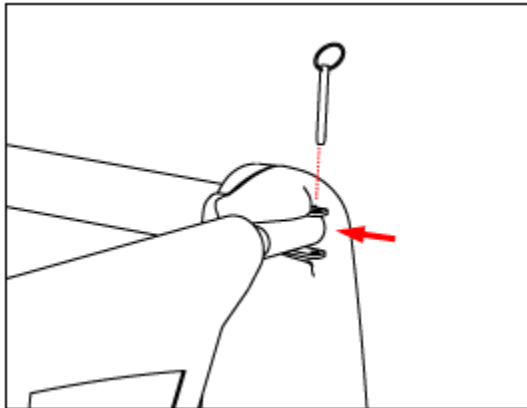

Remove the pins from both sides of the tailgate and lower tailgate.

Step 4:

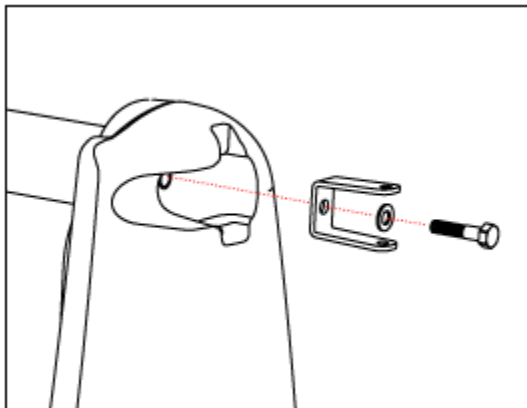

Remove the bolt, small washer, and tailgate bracket from the upper corner of the rear frame. This will only be needed on the side where the fender is being replaced. Removing this will allow you to move the upper frame tube after removing the bolts from the fender.

Parts:

- 1 – Tailgate bracket
- 1 – M8 x 40mm bolt
- 1 – M8 small washer

Step 5:

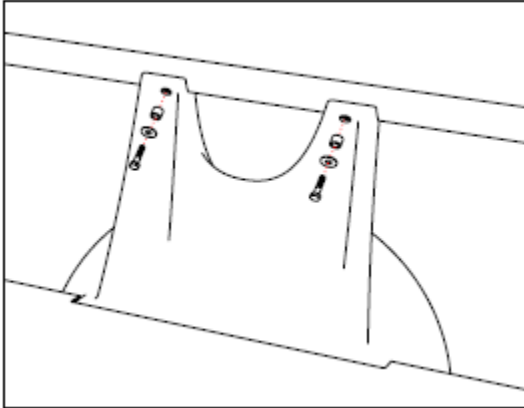

Remove the bolts, washers, and spacers from the upper part of the fender.

Parts:

- 2 – M8 x 40mm bolts
- 2 – M8 large washers
- 2 – Fender spacers

Step 6:

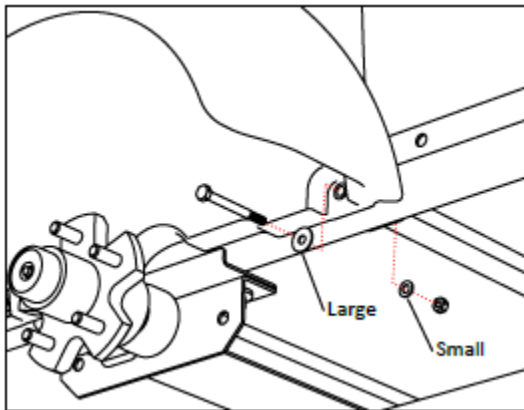

Remove the bolts, washers, and nuts from the lower fender holes.

Parts:

- 2 – M8 x 80mm bolts
- 2 – M8 large washers
- 2 – M8 small washers
- 2 – M8 nuts

Step 7:

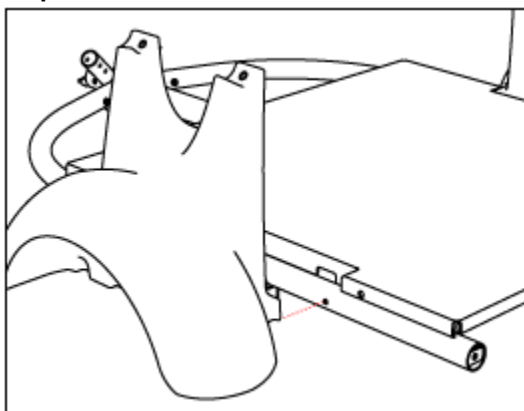

Remove the old *Fender* and install the new *Fender* by aligning the bottom two holes with the holes on the *Lower Frame Tube*. The *Frame Tube* should nest in the concave feature on the bottom of the *Fender*.

Parts:

- 1 – Fender with spacers installed

Step 8:

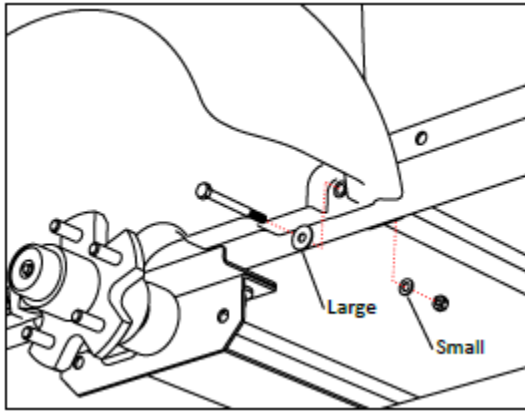

Install washers, bolts, and nuts in the lower *Fender* holes to secure it to the *Frame Tube*. *Bolts* should pass through *fender spacers*, *Frame Tube*, and (if installed) the *Deck* flange slotted holes.

Parts:

- 2 – M8 x 80mm bolts
- 2 – M8 large washers
- 2 – M8 small washers
- 2 – M8 nuts

Step 9:

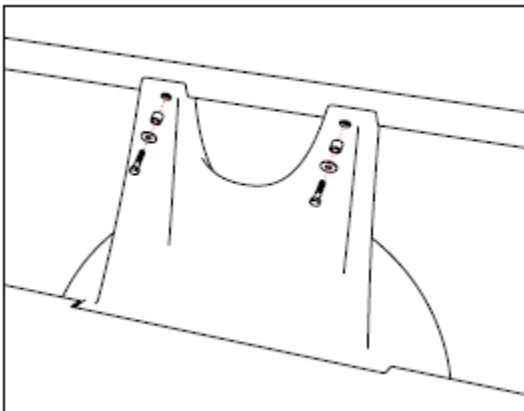

Align upper *Fender* holes with threaded inserts in the *Upper Frame Tube*.

Parts:

- 2 – M8 x 40mm bolts
- 2 – M8 large washers
- 2 – *Fender* spacers

Step 10:

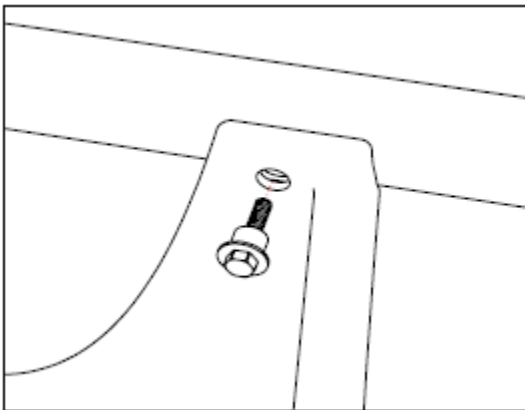

When installing *Fender bolts* place the *washer* and *fender spacer* onto the *bolt* first, then insert it into the hole. The *bolt* threads should engage the threaded insert in the frame tube. Align the *Fender* and pull the *spacer* into the fender hole as you tighten the *bolt* with a wrench. Be careful not to cross thread bolts.

You may fully tighten these two bolts now.

Step 11:

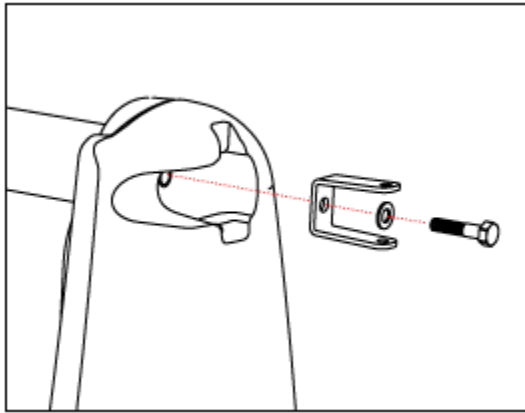

Install Tailgate Bracket, bolt and small washer in upper corner of Rear Frame. Tighten bolts. Make sure bracket remains vertical. Use a wrench to hold it in place while tightening the bolt if necessary.

Parts:

- 1 – Tailgate Bracket
- 1 – M8 x 40 mm bolt
- 1 – M8 small washer

Step 12:

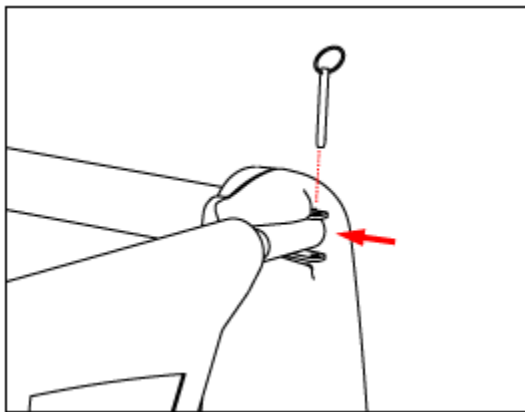

Raise Tailgate and insert retaining pins

Parts:

- 1 - Tailgate
- 2 – Retaining pins

Step 13:

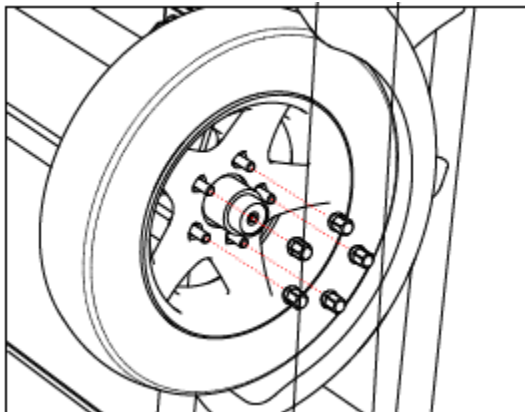

Install Wheel and Lug Nuts and then lower trailer.

Parts:

- 1 - Wheel
- 5 – Lug Nuts

Step 14:

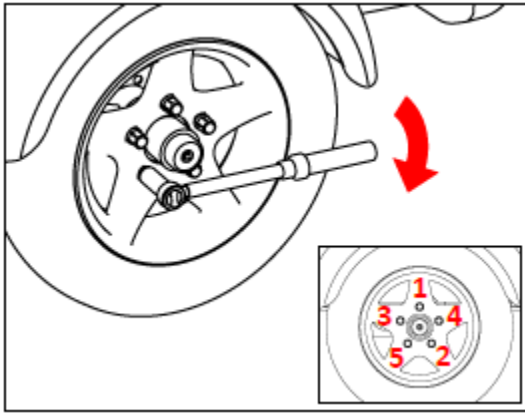

Fully tighten lug nuts in three stages following the tightening sequence at lower right for each stage. Use 19mm (3/4") socket.

Stage 1: 20 – 25 ft-lb. torque

Stage 2: 35 – 40 ft-lb. torque

Stage 1: 50 – 75 ft-lb. torque